

# THE BARKS CAMP MAP

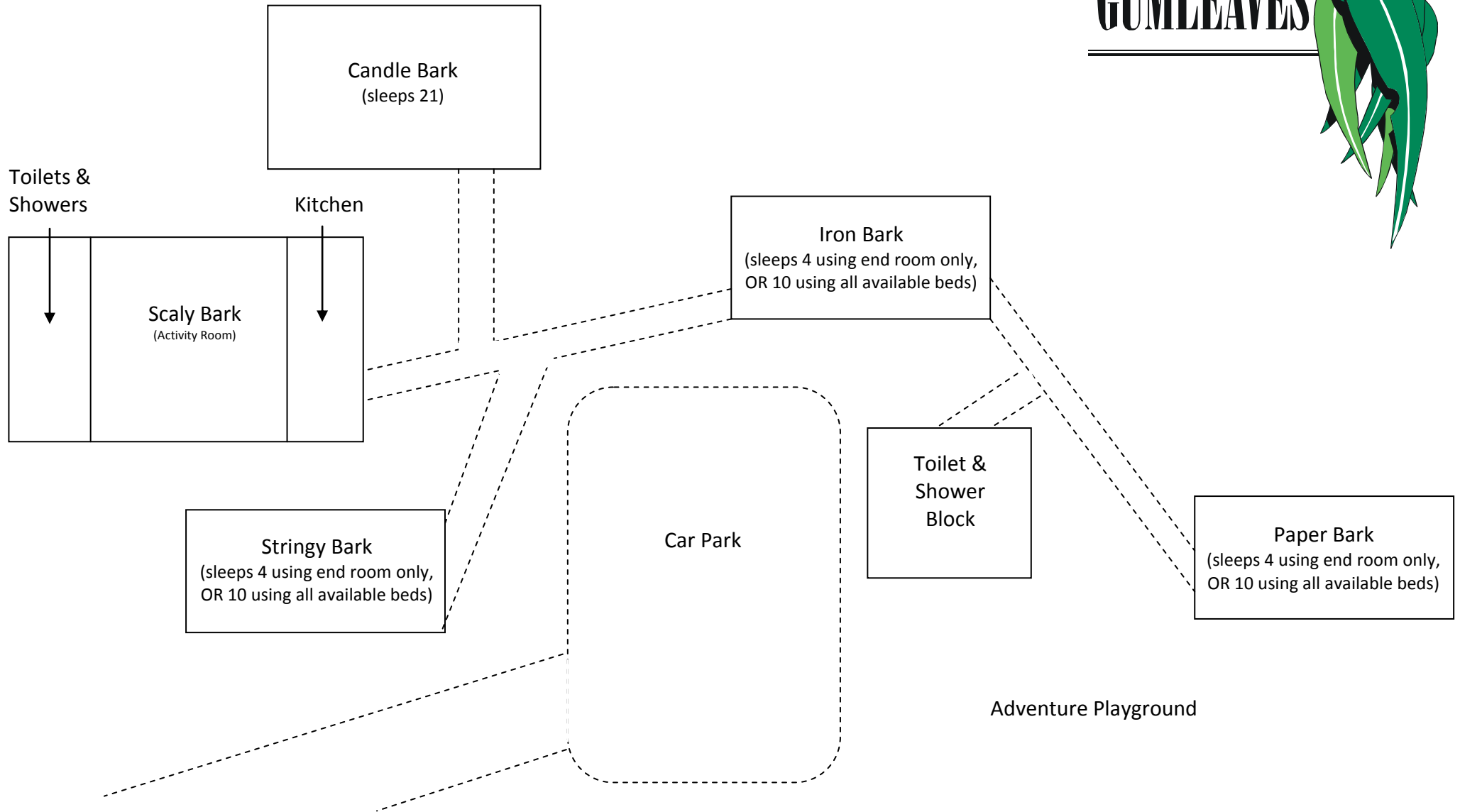

**Maximum accommodation capacity is 51**

# THE BARKS FLOOR PLANS

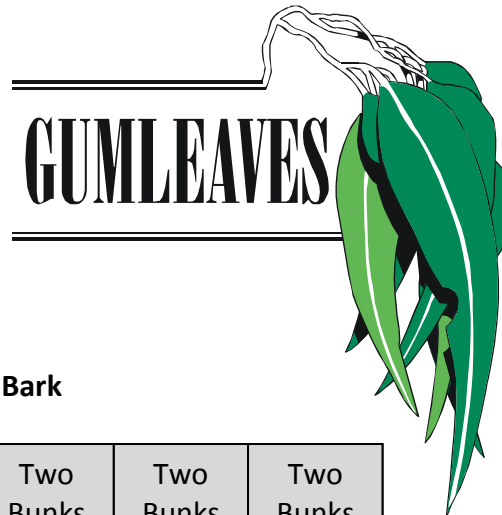

Iron Bark, Paper Bark & Stringy Bark

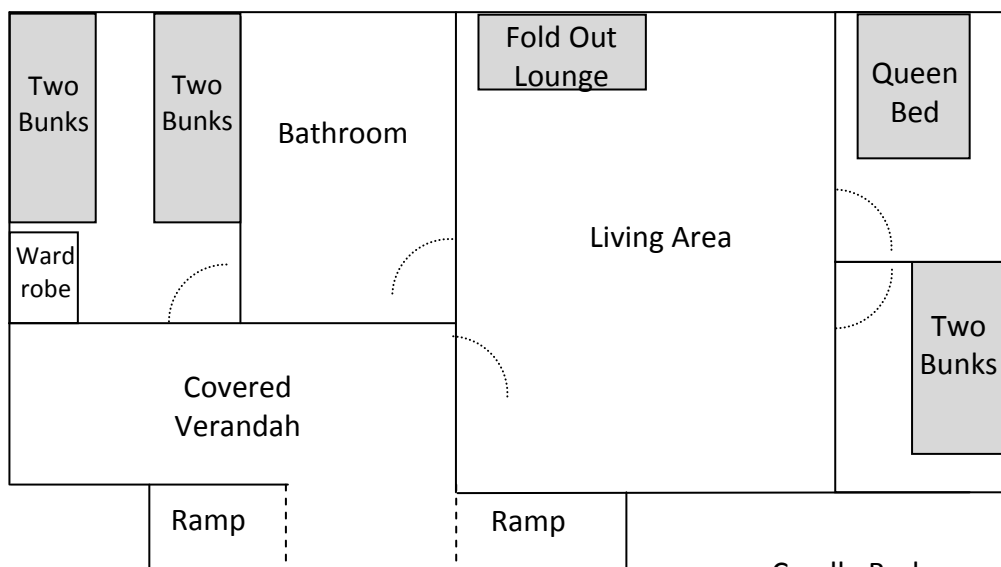

Candle Bark

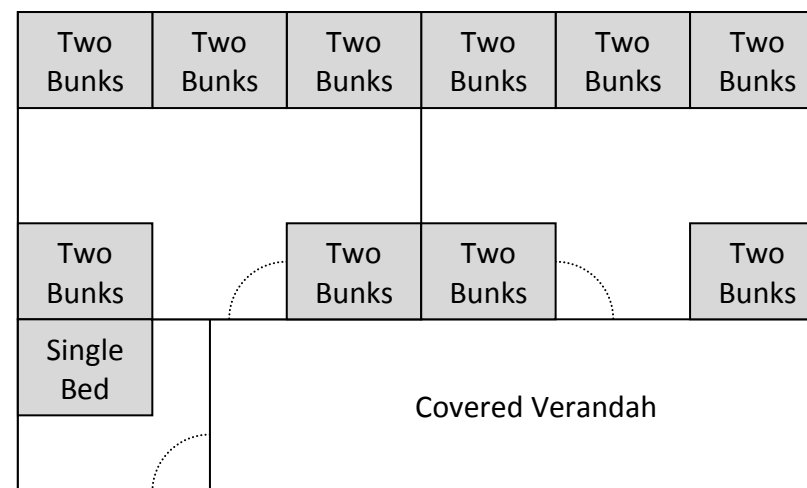

Candle Bark	Sleeps 21
Iron Bark	Sleeps 10
Paper Bark	Sleeps 10
Stringy Bark	Sleeps 10
<hr/> Total Beds	<hr/> 51

**Maximum accommodation capacity is 51.**

This is using all available beds in each of the cabins – including the living areas. As a rule, Candle Barks beds must be filled first. If the group numbers exceed 21, the end rooms in each of the other cabins must be filled next (four single beds per cabin) and the living areas in each of these cabins should be filled last (two doubles and two single beds per cabin).

# GUM GROVE CAMP MAP

**GUMLEAVES**



Bogg Gum  
Toilet &  
Shower  
Block

Squiggly Gum  
Activity Room

Red Gum  
(sleeps 15)

Blue Gum  
(sleeps 15)

Tuan Gum  
Log Cabin  
Kitchen &  
Dining Room

White Gum  
(sleeps 15)

Ghost Gum  
(sleeps 19)

Covered  
BBQ  
Area

Turning  
Circle

Large  
Outdoor  
Fire

Car Park

Adventure  
Playground

**Maximum accommodation  
capacity is 64**

# GUM GROVE FLOOR PLANS



## White/Blue/Red Gum

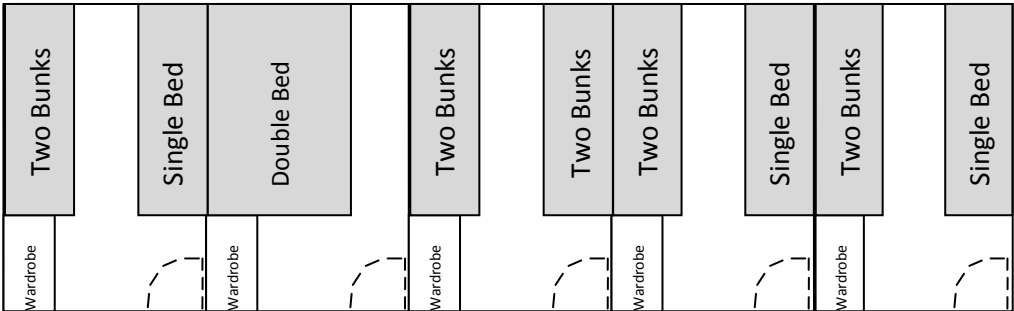

## Ghost Gum

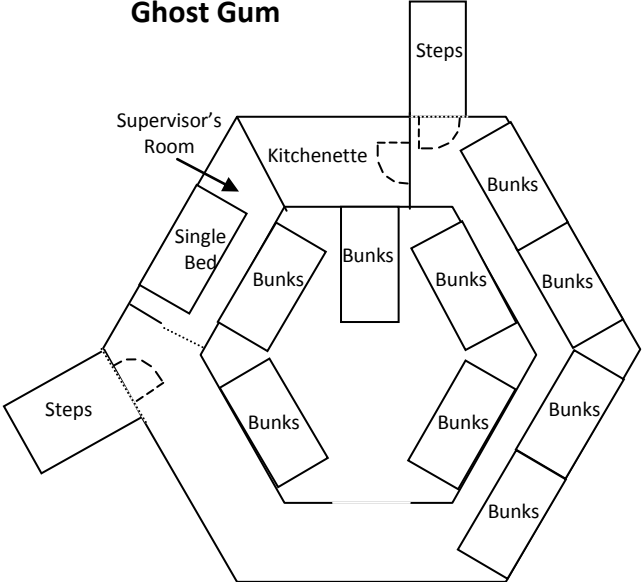

White Gum	Sleeps 15
Red Gum	Sleeps 15
Blue Gum	Sleeps 15
Ghost Gum	Sleeps 19
<b>Total Beds</b>	<b>64</b>

Rooms 1, 4 and 5 in Red, Blue and White Gum have two bunks and one single bed (sleeps three guests)  
 Room 2 in Red, Blue and White Gum has a double bed (sleeps one or two guests)  
 Room 3 in Red, Blue and White Gum has two sets of bunks (sleeps four guests)